

- Aluminium alloys (A)
- Copper alloys (C)
- High grade steel (St)

## Adapters with limit switch including blank caps



1205 A

For fitting to pipework for filling tanks and silos from tank trucks, as well as to coupling stations for in-plant product distribution. Preferably for pipework in which bulk goods or liquids are carried. Signalling of filling processes - Activation of overflow safeguard - Energization of the exhaust air filters - Opening of stop valves - Closing of silo pilots - Release of the feed process - Checking of line connection - Discharge prevention during filling - Changeover of silo scales to fill recording.

### Limit switch as a position sensor with snap-action contact

Switch make:	Telemecanique XCM - A 110
Switch function:	1 break contact + 1 make contact
Contact rating:	6 A at 250 Volt AC
Protective standard:	IP 67
Ambient temperature:	-25°C - +70°C
Cable lengths-Ø:	2 + 10 m (5x0,75)

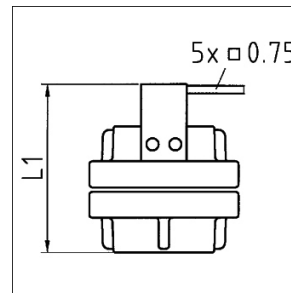

1205 A

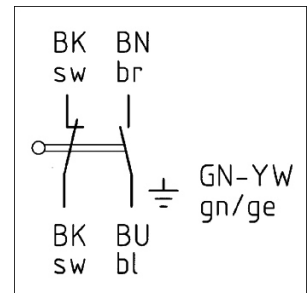

1205 A

Nominal size	Lug spacing b (mm)	Inside dia. d (mm)	Female thread W	Face-to-face length L (mm)	Cable length (m)	Weight (kg)	Ident-No.	Remarks	Alloy
52=C	66	44	G 2	110,5	2	0,900	60348833		A
52=C	66	44	G 2	110,5	10	1,600	60344333		A
65	81	58	G 2½	102	2	1,200	60363133		A
65	81	58	G 2½	102	10	1,900	60363233		A
75=B	89	65	G 2½	114	2	1,250	60348933		A
75=B	89	65	G 2½	114	10	1,875	60344433		A

Nominal size	Lug spacing b (mm)	Inside dia. d (mm)	Female thread W	Face-to-face length L (mm)	Cable length (m)	Weight (kg)	Ident.No.	Remarks	Alloy
75=B	89	65	G 3	114	2	1,200	60345833		A
75=B	89	65	G 3	114	10	1,900	60344533		A
90-DS	105	78	G 3	115	2	1,500	60349033		A
90-DS	105	78	G 3	115	10	2,225	60344733		A
100	115	89	G 4	120	2	2,045	60349133		A
110=A-DS	133	100	G 4	121	2	2,550	60349233		A
110=A-DS	133	100	G 4	121	5	2,900	60361133		A
110=A-DS	133	100	G 4	121	10	3,250	60344633		A
125-DS	148	115	G 5	127	2	3,200	60349333		A
150-DS	160	130	G 6	160	2	3,900	60367733		A