

# FireLock® V10

## Models V1001, V1003, V1005, V1007, V1009, V1011, V1013

### Window Sprinklers



Window Sprinklers

### Approvals/Listings:



See Victaulic Publication [10.01](#) for more details.

### Product Description:

The Model V10 Window Sprinklers are specially designed open style nozzles that provide a 180° relatively flat fan-shaped spray pattern. They are generally used to provide a water curtain over a glass window or other opening to prevent fire/heat penetration. Other uses are to provide fire exposure protection from one closely located building to another and to protect steel beams and columns to preserve structural integrity.

The water flow to the Model V10 Window Sprinklers is controlled either by a manually operated control valve or by means of an automatically operated deluge system.

Model V10 Window Sprinklers may be installed in various positions depending on the hazard being protected. The Window Sprinkler installation diagram shown on page 3 represents a typical installation for the protection of glass windows. However, NFPA 13 should be consulted for the proper installation and spacing of the Model V10 Window Sprinklers.

### Technical Specifications:

**Models:** V1001, V1003, V1005, V1007, V1009, V1011, V1013

**Style:** Window Sprinkler

**Nominal Orifice Size:** See chart on page 2

**K Factor:** See chart on page 2

**Nominal Thread Size:** See chart on page 2

**Max. Working Pressure:** 175 psi/1200 kPa

### Material Specifications:

**Body:** Brass per UNS C36000

### Sprinkler Finishes:

Plain Brass

Proprietary Nickel Teflon<sup>1</sup> coating<sup>2</sup>

VC-250<sup>3</sup>

Chrome plated and other finishes available upon request

For cabinets and other accessories refer to separate sheet.

<sup>1</sup> Teflon is a registered trademark of Dupont Co.

<sup>2</sup> UL Listed for corrosion resistance.

<sup>3</sup> UL Listed and FM Approved for corrosion resistance.

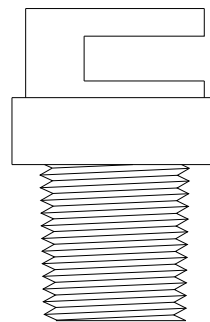

Exaggerated for clarity

### Job/Owner

System No.	
Location	

### Contractor

Submitted By	
Date	

### Engineer

Spec Section	
Paragraph	
Approved	
Date	

**Approvals/Listings:**

APPROVALS/LISTINGS	Model						
	V1001	V1003	V1005	V1007	V1009	V1011	V1013
Orifice Size (inches)	1/4"	5/16"	3/8"	7/16"	1/2"	17/32"	5/8"
Orifice Size (mm)	7	8	10	11	13	14	16
Thread Size (inches)	1/2"	1/2"	1/2"	1/2"	1/2"	3/4"	3/4"
Thread Size (mm)	13	13	13	13	13	19	19
Nominal K Factor Imperial	1.4	1.9	2.8	4.2	5.6	8.0	11.2
Nominal K Factor S.I. <sup>4</sup>	2.0	2.9	4.0	5.9	8.1	11.5	16.3
Height (inches)	1 3/4"	1 3/4"	1 3/4"	1 3/4"	2 1/16"	2 1/16"	2 1/16"
Height (mm)	44	44	44	44	52	52	52

<sup>4</sup> For K Factor when pressure is measured in Bar, multiply S.I. units by 10.0

**Dimensions:**

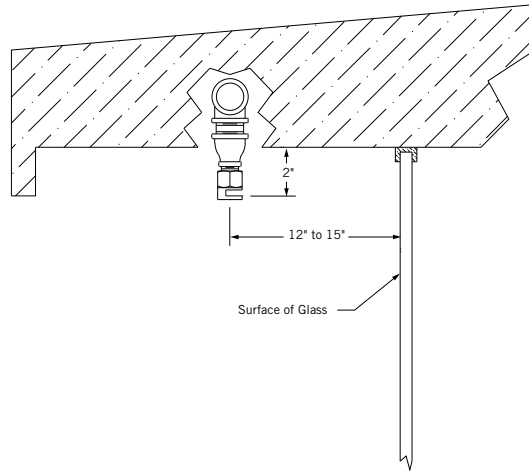

**Distribution Patterns:**

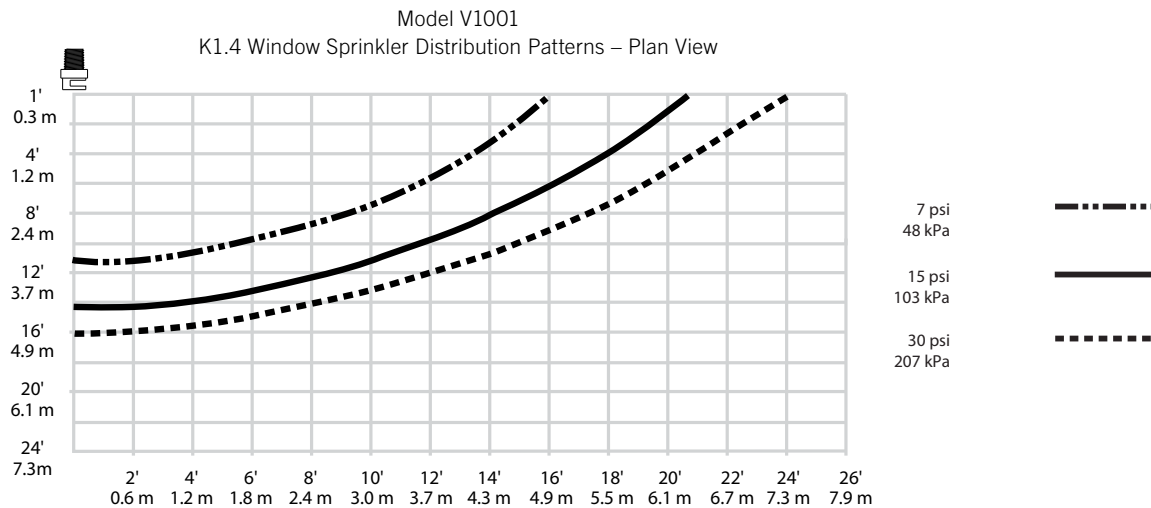

**Distribution Patterns:**

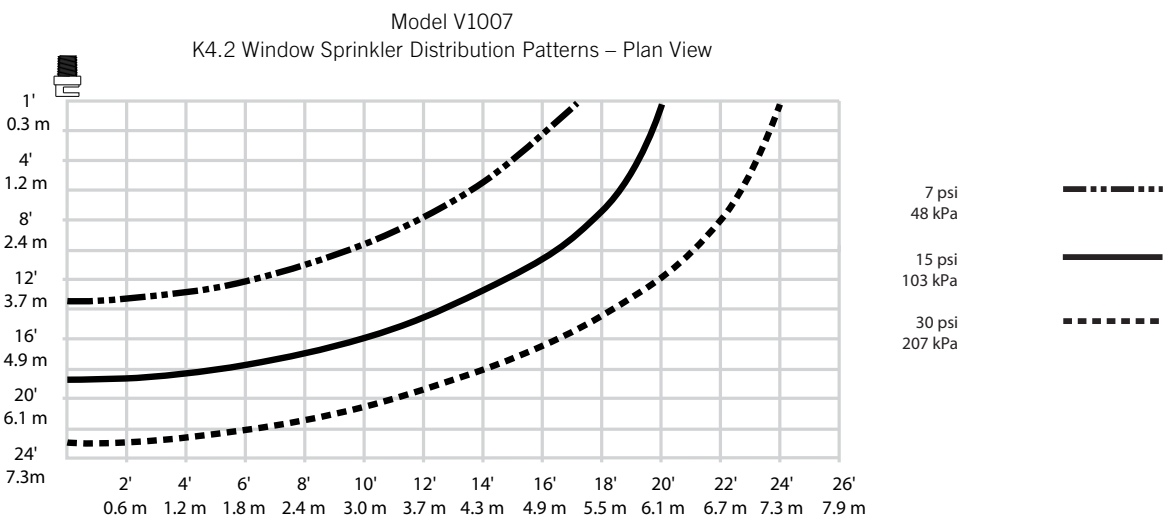
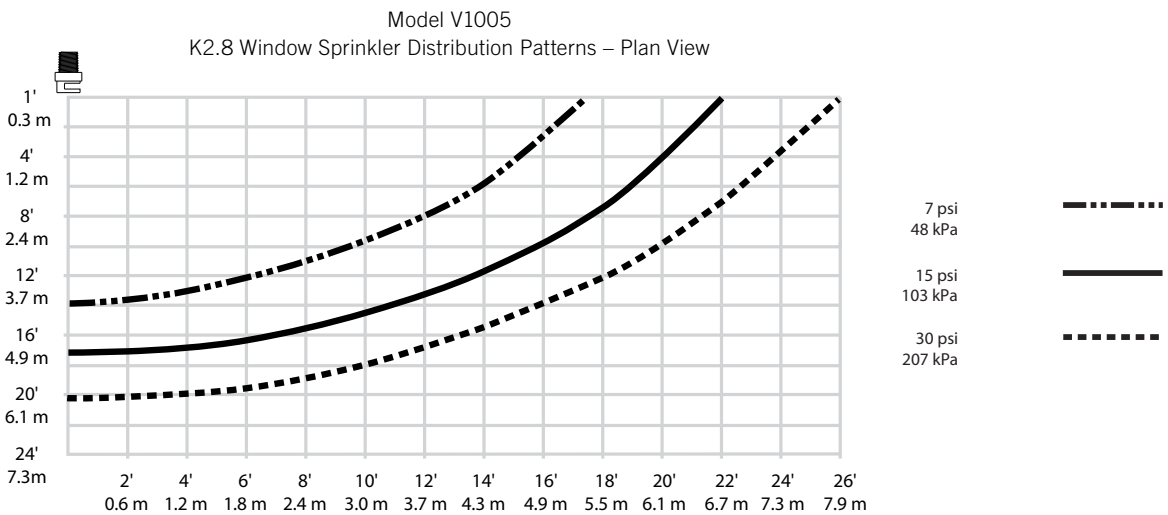
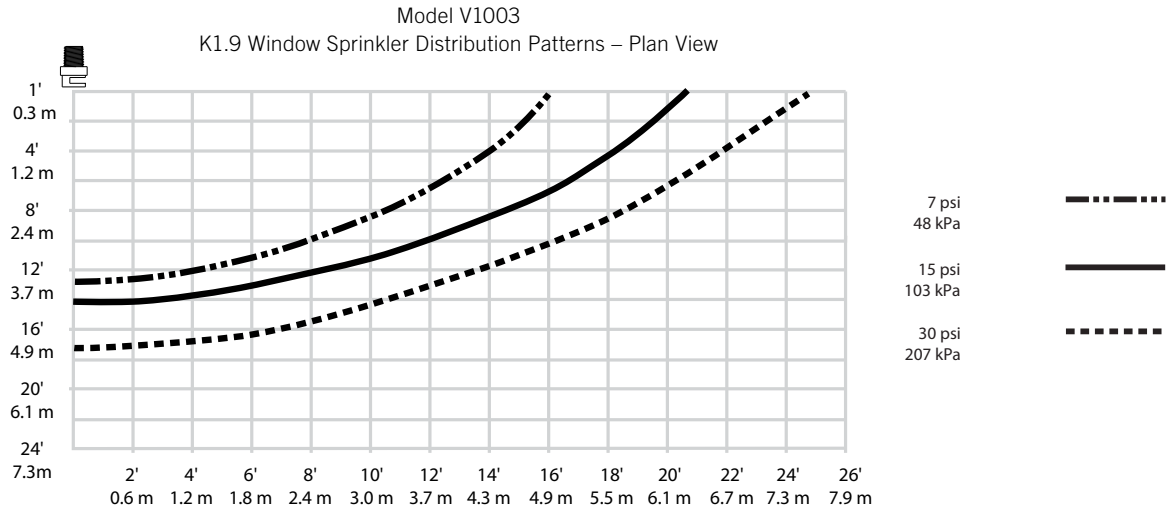

**Distribution Patterns:**

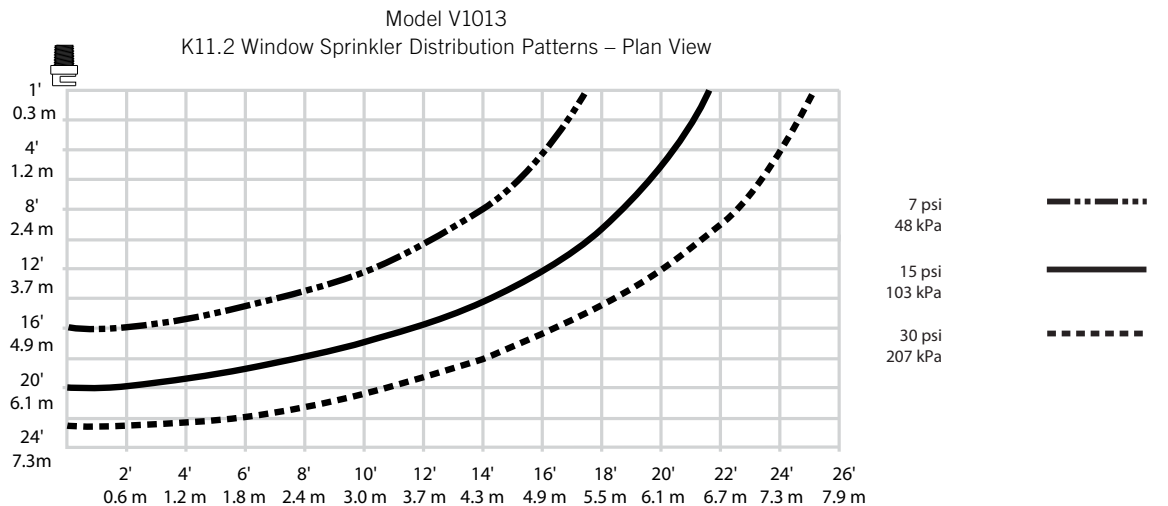
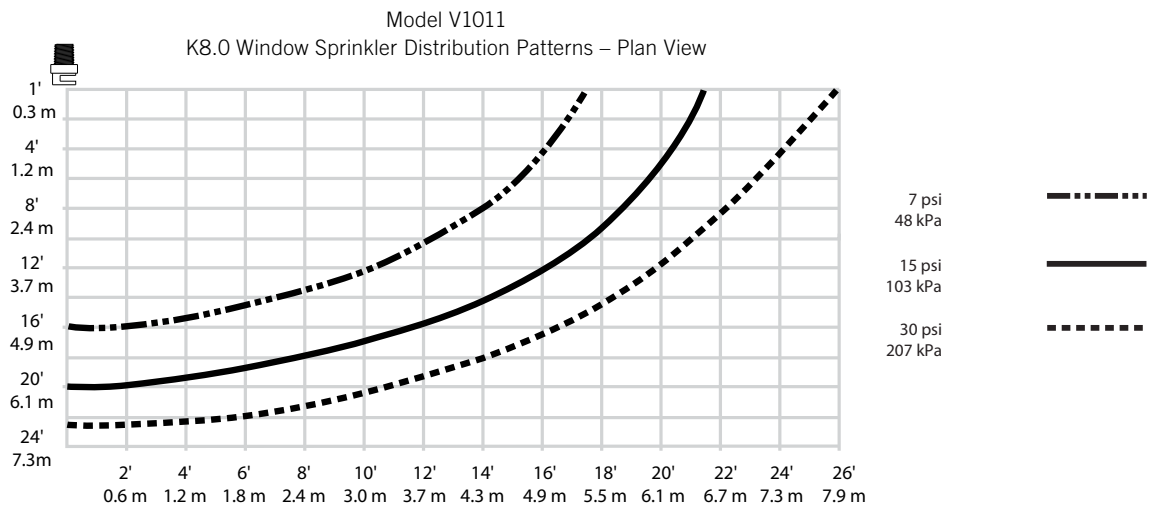
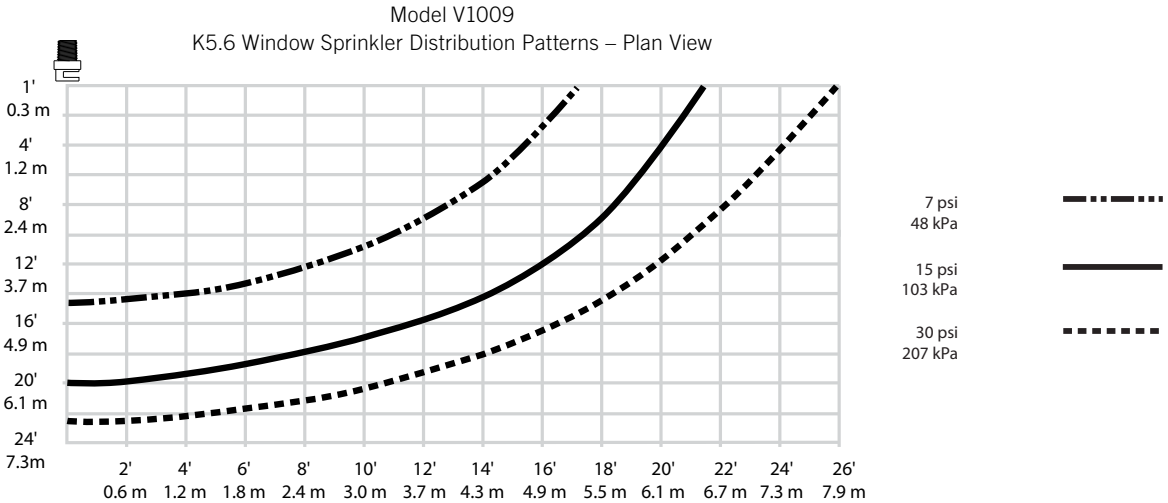

**NOTES:**

- A. Data shown is approximate and can vary due to differences in installation.
- B. These graphs illustrate approximate trajectories, floor-wetting, and wall-wetting patterns for these specific Victaulic FireLock Automatic Sprinklers. They are provided as information for guidance in avoiding obstructions to sprinklers and should not be used as minimum sprinkler spacing rules for installation. **Refer to the appropriate NFPA National Fire Code or the Authority Having Jurisdiction for specific information regarding obstructions, spacing limitations and area of coverage requirements.** Failure to follow these guidelines could adversely affect the performance of the sprinkler and will void all Listings, Approvals and Warranties.
- C. All patterns are symmetrical to the centerline of the waterway.

**WARNING**



- Always read and understand installation, care, and maintenance instructions, supplied with each box of sprinklers, before proceeding with installation of any sprinklers.
- Always wear safety glasses and foot protection.
- Depressurize and drain the piping system before attempting to install, remove, or adjust any Victaulic piping products.
- Installation rules, especially those governing obstruction, must be strictly followed.
- Painting, plating, or any re-coating of sprinklers (other than that supplied by Victaulic) is not allowed.

Failure to follow these instructions could result in serious personal injury and/or property damage.

The owner is responsible for maintaining the fire protection system and devices in proper operating condition. For minimum maintenance and inspection requirements, refer to the current National Fire Protection Association pamphlet that describes care and maintenance of sprinkler systems. In addition, the authority having jurisdiction may have additional maintenance, testing, and inspection requirements that must be followed.

If you need additional copies of this publication, or if you have any questions about the safe installation of this product, contact Victaulic World Headquarters: P.O. Box 31, Easton, Pennsylvania 18044-0031 USA, Telephone: 001-610-559-3300.

**Installation**

Reference should always be made to the I-40 Victaulic FireLock Automatic Sprinklers Installation and Maintenance Sheet for the product you are installing. This installation sheet is included with each shipment of Victaulic products for complete installation and assembly data, and is available in PDF format on our website at victaulic.com.

**Warranty**

Refer to the Warranty section of the current Price List or contact Victaulic for details.

**Note**

This product shall be manufactured by Victaulic or to Victaulic specifications. All products to be installed in accordance with current Victaulic installation/assembly instructions. Victaulic reserves the right to change product specifications, designs and standard equipment without notice and without incurring obligations.

**Trademarks**

Victaulic is a registered trademark of Victaulic Company.