



Capacitive Sensors Series 40 - NAMUR EN 60947-5-6

Housing Ø 18 mm

- Housing material: Brass
- Sensing distance 1...6 mm adjustable, if used in connection with the switching amplifier TS-120...

Certificate:



Technical data

Flush mountable

Operating distance S_n	5 mm
Operating distance min. / max. adjustable	1...6 mm
Electrical version	2-wire DC
Output function	NAMUR DIN 60947-5-6
Type	KAS-40-18/4-N
Art.-No.	400 950
Operating voltage (U_B)	$U_i = 15 \text{ V DC}$
Output current active surface free	< Typ. 1.5 mA
Output current active surface covered	> Typ. 2.5 mA
Self-inductance (L)	0.2 mH
Self-capacitance (C)	250 nF
Permitted residual ripple max.	5%
Frequency of operating cycles max.	50 Hz
Permitted ambient temperature	-25...+70 °C
LED-display	-
Degree of protection IEC 60529	IP 67
Connection cable	2 m, PUR, 2 x 0.14 mm ²
Housing material	Brass
Active surface	PTFE (FDA 21 CFR 177.1550)
Lid	-

All specifications are subject to change without notice. (14.04.2010)

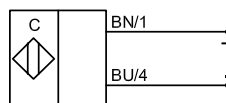
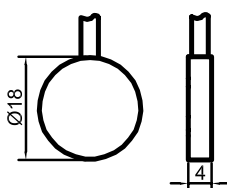

Made in Germany